

60' DRAINAGE AND UTILITY EASEMENT FROM CITY OF WILMINGTON

MF-M

ST. ANDREWS DRIVE
CITY OF WILMINGTON PROPERTY

CITY OF WILMINGTON CORP. LIMITS-LINE

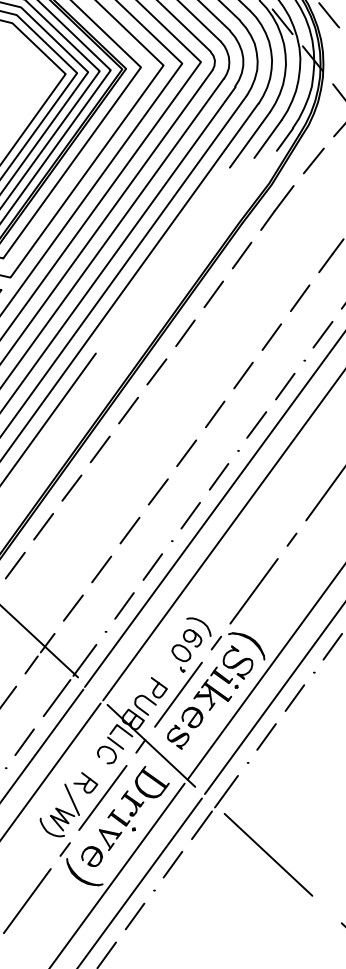

(Sikes Drive) (60' PUBLIC R/W)

MF-M

Anticipated Development Schedule:
 Permitting 3-4 months
 Phase I 1-2-18 months
 Phase II 1-2-24 months
 48 month completion date from beginning of permit anticipated (resizing application package)

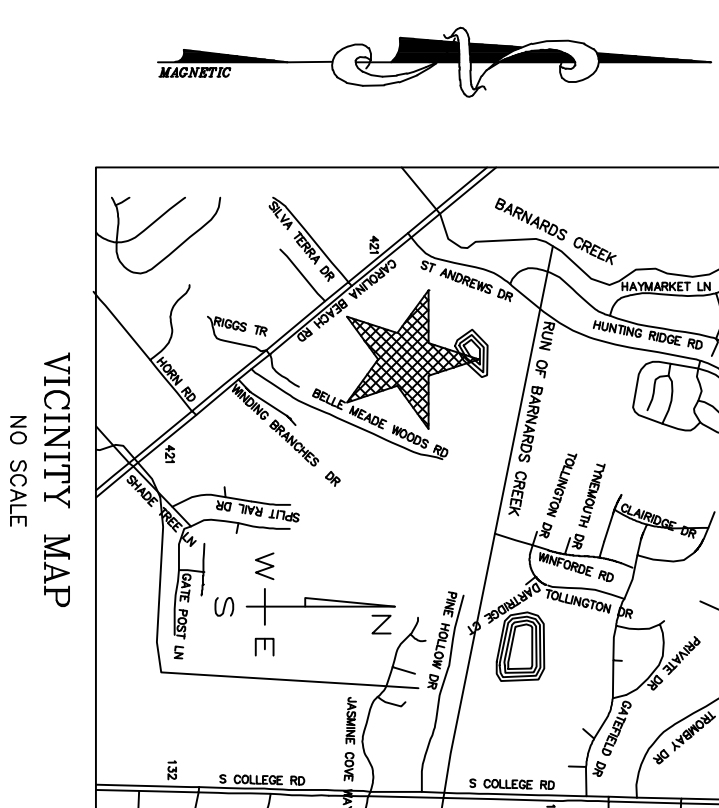

NO SCALE

Area Use Data				
Area	Building Square Footage	Use	Parking Required	Parking Provided
A	8,000	Retail 8,000	1 per 400 sq. ft.	36
B	8,000	Retail 8,000	1 per 400 sq. ft.	36
C	5,194	Movie Theater	1 per 4 seats	656
Total	67,941		696	728

Area	Building Square Footage	Use	Parking Required	Parking Provided
A	17,500	Drug Store	1 per 400 sq. ft.	44
B	14,400	Office 7,200	1 per 400 sq. ft.	37
C	21,000	Retail 10,500	1 per 400 sq. ft.	53
D	9,900	Office 4,950	1 per 400 sq. ft.	23
E	7,800	Retail 3,900	1 per 400 sq. ft.	22
F	21,000	Retail 10,500	1 per 400 sq. ft.	55
G	14,400	Office 7,200	1 per 400 sq. ft.	40
Total	105,100		262	290

Area	Building Square Footage	Use	Parking Required	Parking Provided
H	14,445	Bank	1 per 150 sq. ft.	59
I	5,075	Grocery Store	1 per 420 sq. ft.	194
J	9,200	Retail	1 per 420 sq. ft.	23
K	14,000	Office 7,000	1 per 400 sq. ft.	36
L	19,210	Office	1 per 400 sq. ft.	48
Total	100,930		273	360

GENERAL NOTES:
 1. Significant items on site will be retained if not located in building footprint, parking lot or sidewalk area or if removal is required due to grade change. See site-specific requirements.
 2. All utility lines shown are approximate. See utility records for exact locations.
 3. Other use above still may be changed to residential use with special use permit.

List of Permitted Uses on the (CD) B-1 Site (22 uses)		List of Permitted Uses on the (CD) B-2 Site (23 uses)	
Accessory Buildings or Uses, & Buildings	Government Offices	Accessory Buildings or Uses, & Buildings	Government Offices
Approved Use of Building	Home Furnishing & Equipment	Approved Use of Building	Home Furnishing & Equipment
Apparel & Accessory Store	Miscellaneous Retail	Apparel & Accessory Store	Home Furnishing & Equipment
Banks, Credit Agencies, Savings & Loans	Indoor & Outdoor Recreation Establishments	Banks, Credit Agencies, Savings & Loans	Indoor Theater
Barber/Beauty Shop	Business Services Including Printing & Professional Activities	Barber/Beauty Shop	Miscellaneous Retail
Business Services Including Printing & Professional Activities	Personal Services	Business Services Including Printing & Professional Activities	Indoor & Outdoor Recreation Establishments
Children's Day Care	Drug Store	Children's Day Care	Offices for Private Business & Professional Activities
Drug Store	Dry Cleaning/Laundry Plant	Drug Store	Personal Services
Dry Cleaning/Laundry Plant	Eating & Drinking Places	Dry Cleaning/Laundry Plant	Principal Use Sign
Eating & Drinking Places	Food Stores	Eating & Drinking Places	Watch, Clock & Jewelry Repair
Food Stores	General Merchandise Stores	Food Stores	Temporary Sign
General Merchandise Stores		General Merchandise Stores	Residential

Area "A" (CD) B-1 to (CD) B-2
 AVERAGE SIZE 4,826 SQ. FT. 2,626 SEATS

Area "B" remains (CD) B-1
 AVERAGE SIZE 2,582 SQ. FT. 2,626 SEATS

Area "C" (CD) B-1
 AVERAGE SIZE 2,533 SQ. FT. 2,626 SEATS

Area "C" (CD) B-1
 AREA CURRENTLY ZONED (CD) B-1 REMAINS (CD) B-1 AVERAGE SIZE 2,533 SQ. FT. 2,626 SEATS

Area "C" (CD) B-1
 AREA CURRENTLY ZONED R-15 REMAINS (CD) B-1 AVERAGE SIZE 2,533 SQ. FT. 2,626 SEATS

CONTRACTOR:
 CIVIL ENGINEER, P.A.
 4400 Corporate Center Blvd.
 Suite 200
 Wilmington, NC 28403
 (910) 763-7707

DESIGNER:
 H. Capps
 J. Brinker

DATE: 10-08-2008

SCALE: 1"=60'-0"

SHEET NO.: 302-00102

LAND USE PLAN

SCALE: 1"=60'-0"

Belle Meade Centre
 Matteo Drive / Carolina Beach Rd.
 Wilmington, North Carolina

HTCA
 Howard T. Capps & Associates, Inc.
 Land Planning Landscape Architecture
 605 North Fourth Street
 Wilmington, North Carolina 28401
 Phone: (910) 763-7708 Fax: (910) 763-7707

REVISIONS	BY
1. REVISIONS	
2. ADD NOTES / CALCULATIONS	
3. NOTE CHANGES	